



GELCAP SL STUB CONNECTION KIT FOR STREET LIGHTS (1000V)

KEY FEATURES

- Fast and easy installation
- Easy re-entry
- PowerGel sealant technology

TE Connectivity's (TE) Raychem GelCap SL stub connection kits provide quick installation, dependable performance, and easy re-entry. These kits quickly and conveniently connect, insulate, seal, and protect stub splice connections up to 1000 volts. The robust yet compact design was engineered to handle the harsh environment of motor connections.

To install a GelCap stub connection kit, simply push the cover down over the connection and snap the clamp closed. The PowerGel sealing gel is already in the cap, no extra material or grease is required.

The corner of the stub connection is easy to re-enter as the PowerGel sealing gel pulls away leaving a clean connection. Re-entry is also safer than other methods because no sharp objects or cutting tools are required for removal of the cap.

The GelCap stub connection kits feature revolutionary PowerGel sealing gel which provides an excellent moisture seal over a wide temperature range (-40°C to 105°C). PowerGel sealing gel has excellent insulating properties and the added benefit of acting as a vibration damper.

Customers can count on consistent, high quality products, driven by TE's proven innovation and backed by our extraordinary customer support.

GelCap Stub Connection Kit (1000V)



PowerGel sealing gel has been in use in other applications for over 10 years. TE gels are ideal for sealing electrical connections from moisture, dirt and other contaminants.

Silicone gel is high dielectric insulation and provides constant pressure on cable and connector to provide water seal. PowerGel sealing gel is specially formulated for high temperature environments.

Molded clamp of UV stable, impact resistant polypropylene secures cover in place.

Molded cover of high abrasive and impact resistant elastomer provides rugged protection for electrical connection.

Snap-lock feature provides quick installation and removal.

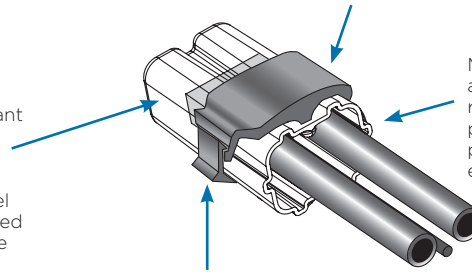

TESTING	
Testing	Test Conditions
Chemical Resistance	ASTM D543, Sulfuric acid, Sodium hydroxide, Transformer and motor oil
Ozone Resistance	ASTM D1149, 120 hours @ 40°C, 50 pphm
Accelerated Aging	ASTM D2671
UV Resistance	ASTM G53, UVB, 4000 hours, 4 hour on/off cycle
Abrasion Resistance	2040 gm wt., 4000 cycles, 5% max thickness loss

PRODUCT SELECTION INFORMATION: DIMENSIONS IN INCHES (mm)				
Description	HOLES "A"		HOLES "B"	
	Wire Range	Recommended Torque Values	Wire Range	Recommended Torque Values
GelCap-SL-2/0-3 Hole	#14 - 2/0 AWG (2 - 70 sq. mm)	120 - 180 in-lbs. (13.6 - 20.3 N-m)	#14 - 6 AWG (2 - 10 sq. mm)	120 - 150 in-lbs. (13.6 - 17 N-m)

TEST REPORT
EDR-5334
EDR-5352



te.com/energy

©2005, 2007, 2012, 2014 TE Connectivity Ltd. family of companies. All Rights Reserved. 1654771 E169 10/2014

PowerGel, Raychem, TE Connectivity and TE connectivity (logo) are trademarks. Other logos, product and/or company names might be trademarks of their respective owners. While TE has made every reasonable effort to ensure the accuracy of the information in this brochure, TE does not guarantee that it is error-free, nor does TE make any other representation, warranty or guarantee that the information is accurate, correct, reliable or current. TE reserves the right to make any adjustments to the information contained herein at any time without notice. TE expressly disclaims all implied warranties regarding the information contained herein, including, but not limited to, any implied warranties of merchantability or fitness for a particular purpose. The dimensions in this catalog are for reference purposes only and are subject to change without notice. Specifications are subject to change without notice. Consult TE for the latest dimensions and design specifications.

FOR MORE INFORMATION: TE Technical Support Centers

USA: +1 800 327 6996
 France: +33 380 583 200
 UK: +44 0870 870 7500
 Germany: +49 896 089 903
 Spain: +34 916 630 400
 Benelux: +32 16 351 731
 Canada: +1 (905) 475-6222
 Mexico: +52 (0) 55-1106-0800
 Latin/S. America: +54 (0) 11-4733-2200
 China: +86 (0) 400-820-6015